

**fischer** 

**DuoBlade.**  
The self-drilling  
plasterboard plug for  
fast installation.



# DuoBlade.

## The self-drilling plasterboard plug for fast and easy installation.

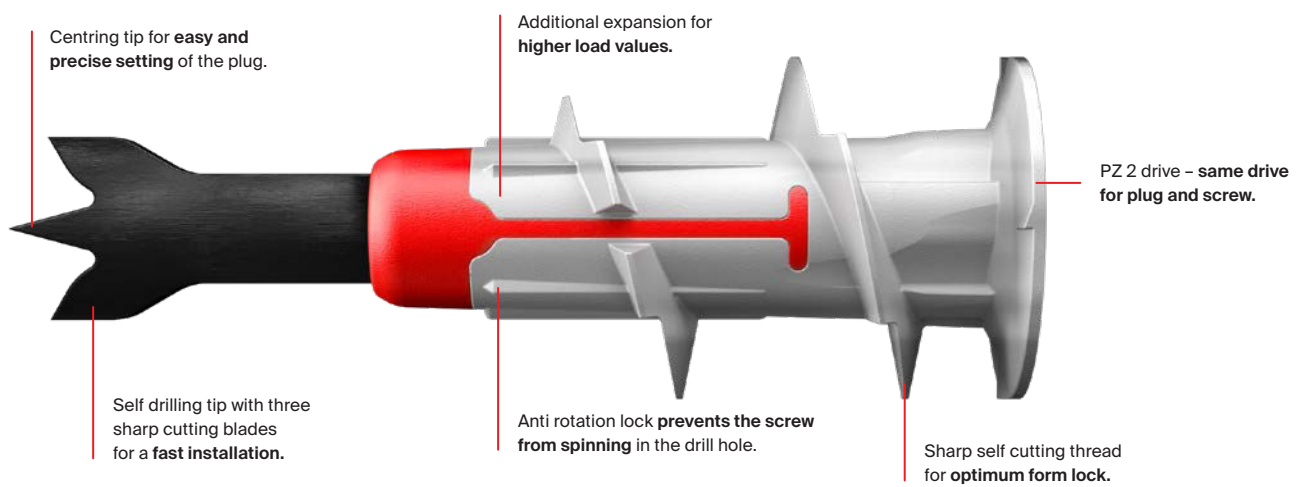

### Recommendation

Suitable for building materials, such as



Gypsum plasterboards

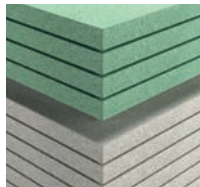

Gypsum fibreboards

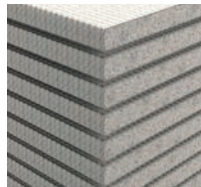

Lightweight cement boards

### Features



# Advantages, Functioning and installation.

## Your advantages at a glance

- An innovative product of the fischer DuoLine with intelligent combinations for more power and more intelligence.
- The self-drilling fischer DuoBlade allows fast and easy installation in gypsum plasterboard and gypsum fibreboard.
- The black metal tip guarantees simple and safe installation.
- High torque when anchor is installed for the feelgood-factor and an optimum feeling when setting.

## Functioning

- The fischer DuoBlade is suitable for pre-positioned installation.
- The metal tip for better heat-resistant and cutting characteristics. Especially in double-layered plasterboard.
- The fischer DuoBlade can be used with wood, metal and chipboard screws of  $\varnothing$  4.0 to  $\varnothing$  5.0 mm.
- In gypsum fibreboard, pre-drilling with a drill  $\varnothing$  8mm is recommended.

## Installation in panel building materials

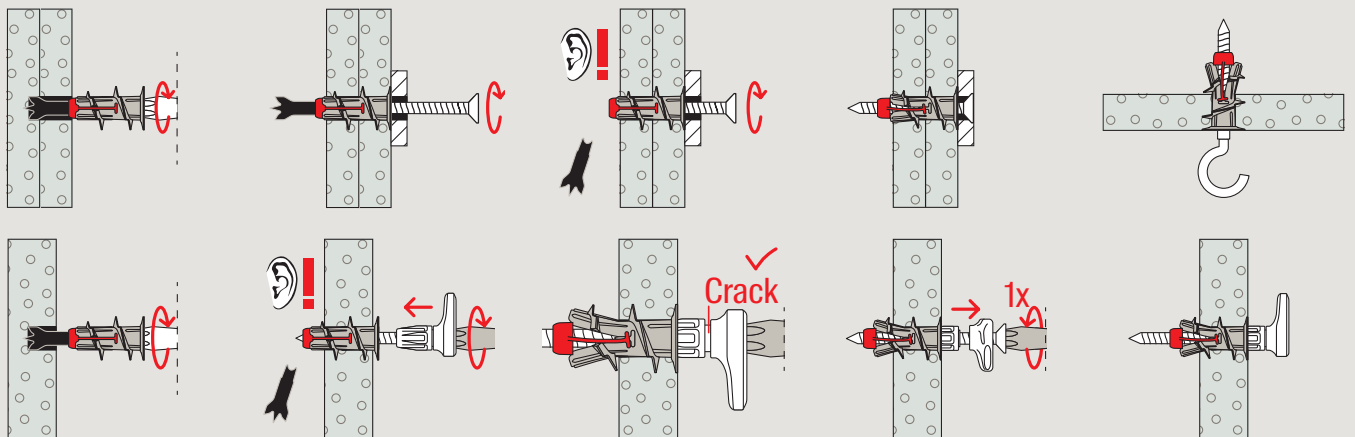

# Applications



Clothes hooks



Mirrors



Lamps



Smoke detectors



Pictures

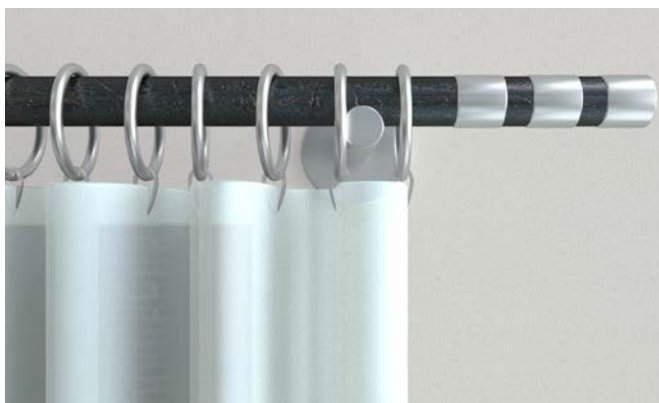

Curtain rods

**EasyHook.**  
Turn screws into  
hooks.



# Assortment and Loads

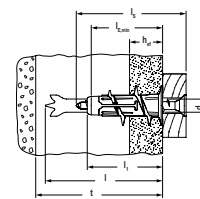

## DuoBlade assortment



Item	Art.-No.	Min. thickness to first supporting layer t [mm]	Anchor length l [mm]	Anchor length without drill tip l <sub>1</sub> [mm]	Anchorage depth h <sub>ef</sub> [mm]	Min. bolt penetration l <sub>E, min</sub> [mm]	Screw d <sub>s</sub> / d <sub>s</sub> x l <sub>s</sub> [mm]	Drive t <sub>fix</sub> [mm]	Sales unit [pcs]
DuoBlade	545675	50	44	29	9.5 - 25	28	4 - 5	-	50
DuoBlade S	545676 <sup>1)</sup>	50	44	29	9.5 - 25	28	4.5 x 40	PZ2	25
DuoBlade K NV	545683	50	44	29	9.5 - 25	28	4 - 5	-	10
DuoBlade S K NV	545684 <sup>1)</sup>	50	44	29	9.5 - 25	28	4.5 x 40	PZ2	6
DuoBlade WH K NV	545685 <sup>2)</sup>	50	44	29	9.5 - 25	28	4.2 x 40	-	6
DuoBlade RH K NV	545686 <sup>3)</sup>	50	44	29	9.5 - 25	28	4.0 x 46	-	6

<sup>1)</sup> DuoBlade S - with chipboard screw countersunk head

<sup>2)</sup> DuoBlade WH - with screw with angle hook

<sup>3)</sup> DuoBlade RH - with screw with round hook

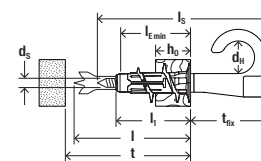

## EasyHook Assortment



EasyHook Angle DuoBlade

EasyHook Round DuoBlade

Item	Art.-No.	Drill-diameter d <sub>o</sub> [mm]	Minimum Drill hole depth h <sub>min</sub> [mm]	Minimum Board thickness [mm]	Minimum screw-in depth [mm]	Plug length l = h <sub>ef</sub> [mm]	Plug screw d <sub>s</sub> x l <sub>s</sub> [mm]	Diameter hook hole d <sub>H</sub> [mm]	Drive	Wall distance t <sub>fix</sub> [mm]	Content Blister
EasyHook Angle DuoBlade	557919	-	-	9.5	28	44	4.0 x 50	-	PZ 2	4.0 - 9.0	6
EasyHook Round DuoBlade	557920	-	-	9.5	28	44	4.0 x 70	-	PZ 2	24 - 28	6

## Plasterboard plug DuoBlade

Highest recommended loads <sup>1)</sup> for a single anchor. The given loads are valid for chipboard screws with the specified diameter.

Type		DuoBlade
Chipboard screw	[mm]	4.5 - 5.0
Recommended loads in the respective base material F <sub>empf</sub> <sup>2)</sup>		
Gypsum plasterboard	9.5 mm	[kN] 0.08
Gypsum plasterboard	12.5 mm	[kN] 0.10
Gypsum plasterboard (e.g. Knauf Diamant Platte or Rigips Die Harte)	12.5 mm	[kN] 0.18
Gypsum plasterboard	2x 12.5 mm	[kN] 0.20
Lightweight cement board	12.5 mm	[kN] 0.08
Gypsum fibreboard	12.5 mm	[kN] 0.34

<sup>1)</sup> Required safety factors are considered.

<sup>2)</sup> Valid for tensile load, shear load and oblique load under any angle.



**DuoLine.**

Intelligent combination for more  
Power and more Intelligence.

Dealer:

[www.fischer-international.com](http://www.fischer-international.com)



**fischer stands for**

Fixing Systems  
Automotive  
fischertechnik  
Consulting  
Electronic Solutions

---

fischerwerke GmbH & Co. KG  
Klaus-Fischer-Straße 1 · 72178 Waldachtal  
Germany  
T +49 7443 12 - 0  
[www.fischer-international.com](http://www.fischer-international.com) · [info@fischer.de](mailto:info@fischer.de)

---